

# Analysis of Crack Propagation in Mechanical Components Presenting Multiples Cracks

Adan VEGA, Josemaría MORAZAN, Carlos  
PLAZAOLA, Ilka BANFIELD

Technological University of Panama

# Outline

1. Introduction
2. Modeling of the crack propagation mechanism
3. Application to real structures
4. Analysis of single cracks
5. Analysis of multiple cracks
6. Conclusions

# Outline

1. Introduction

2. Modeling of the crack propagation mechanism

3. Application to real structures

4. Analysis of single cracks

5. Analysis of multiple cracks

6. Conclusions

1. Design mechanical elements, under the assumption of the absence of defects in their manufacture and then consider its effect by safety factors is risky
2. Reality is that defects and particularly cracks appear either in the manufacturing or generated in service
3. It is therefore necessary to analyze its effect on the performance of the element or structure

# Outline

1. Introduction

**2. Modeling of the crack propagation mechanism**

3. Application to real structures

4. Analysis of single cracks

5. Analysis of multiple cracks

6. Conclusions

# Flow chart of crack propagation modeling

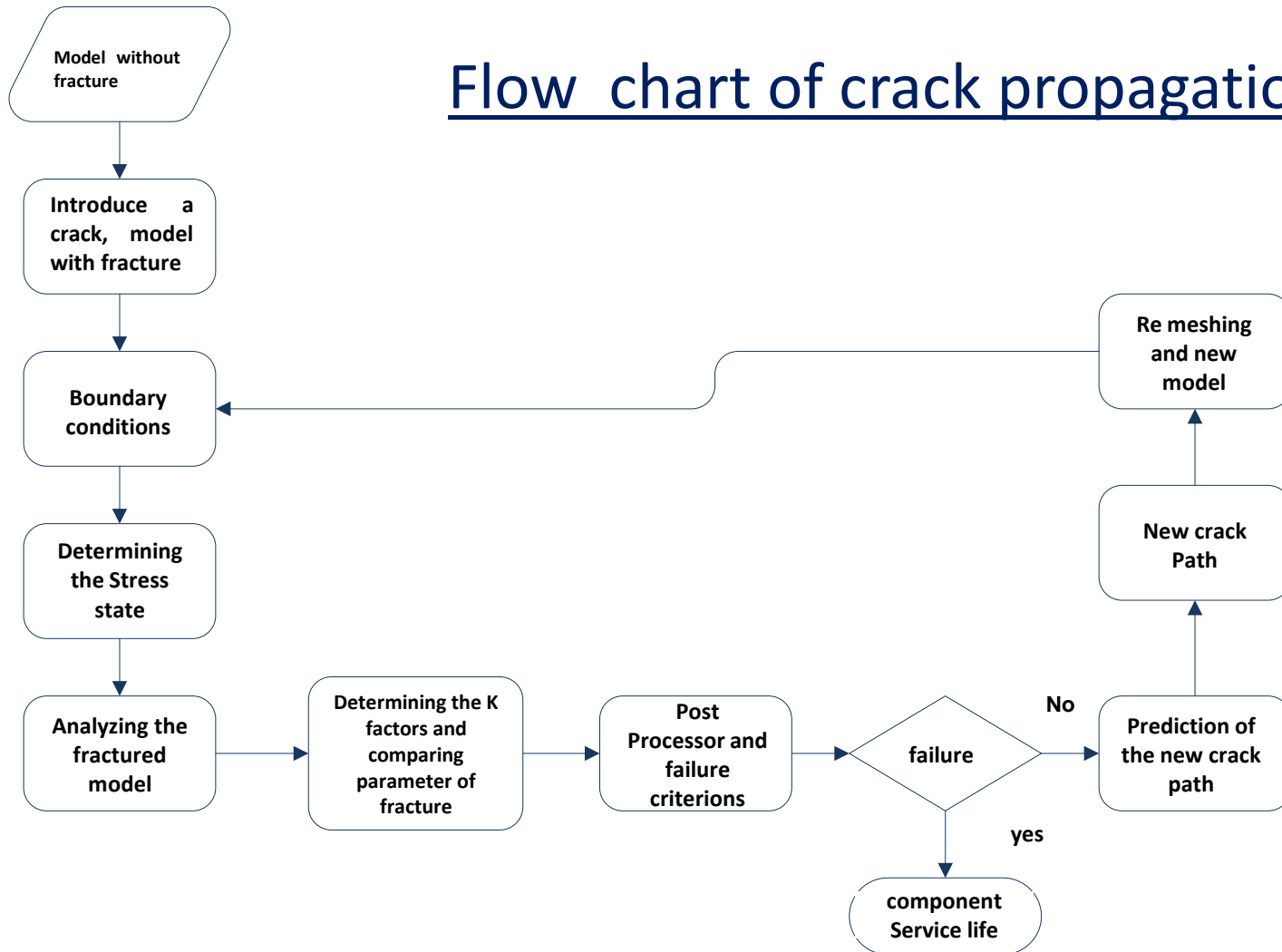

# Working piece

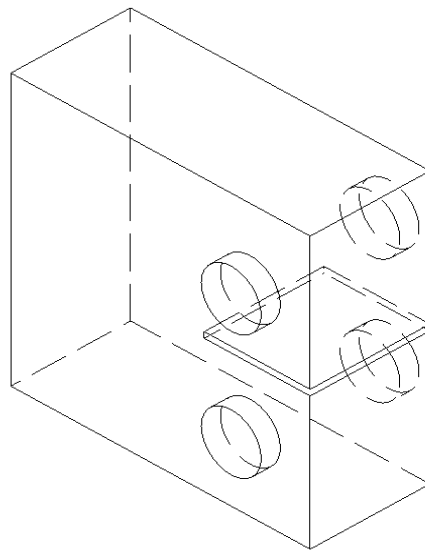

ASTM E-399

Material: AISI/SAE 1045

$\sigma_y = 419 \text{ MPa}$

$\sigma_u = 673 \text{ MPa}$

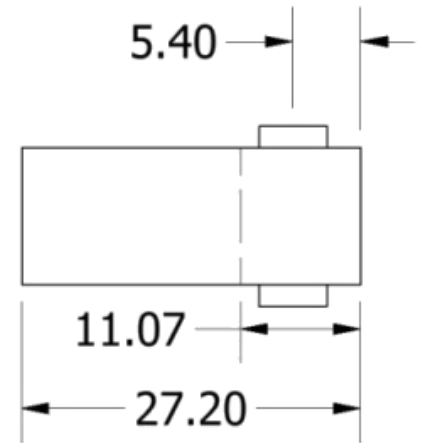
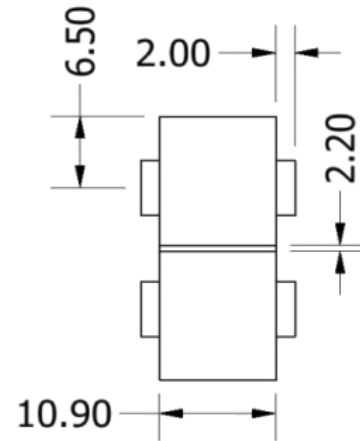
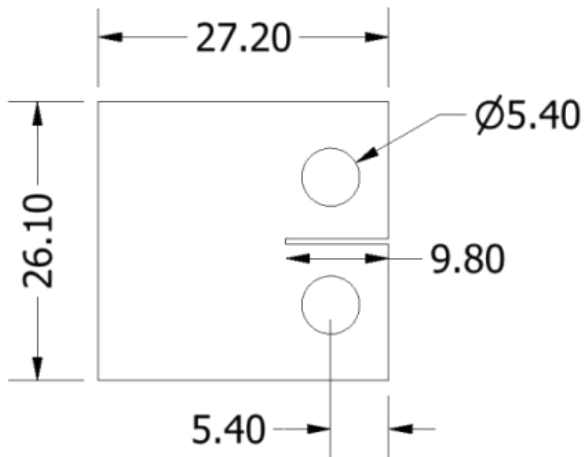

# FEM Model

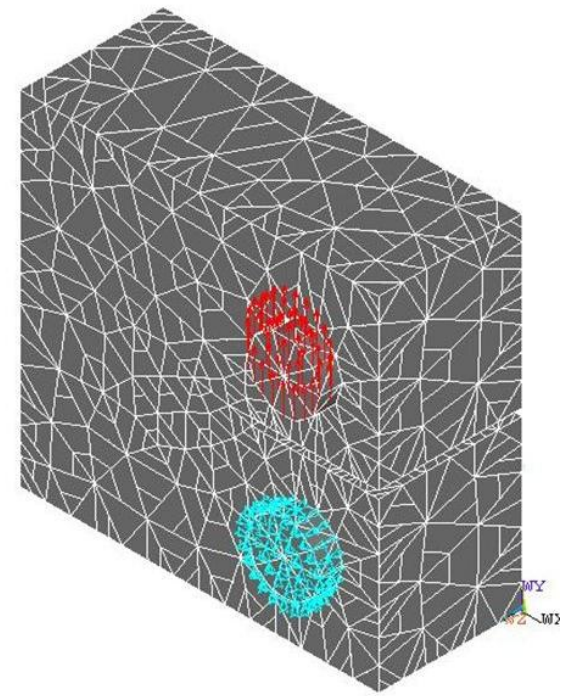
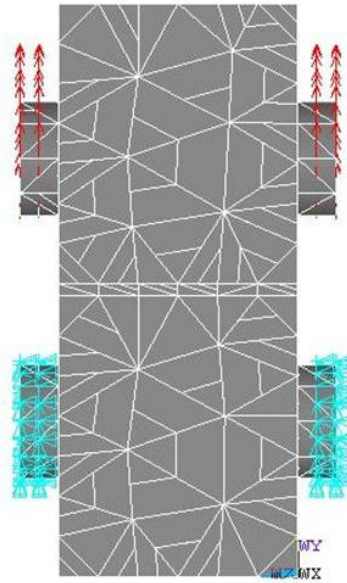
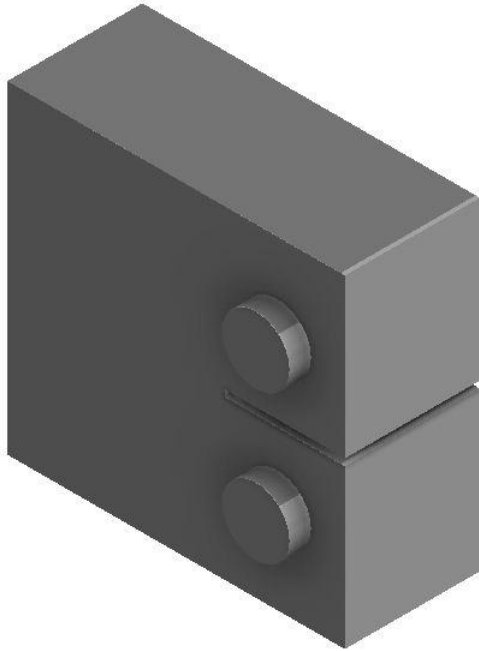

## Software:

1. ANSYS APDL (for stress state generation)
2. Frac3D (to insert the crack)
3. ANSYS Fatigue (to determine the life service)

Type of element	number of element	number of nodes
Tetrahedral	68927	1378540
Parallelepipeds	3200	32000
Wedge	1600	24000
Piramydal	1600	20800
<b>Total</b>	<b>75327</b>	<b>1455340</b>



# Element types around the crack

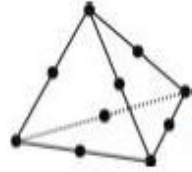

Tetrahedral elements  
far from the crack

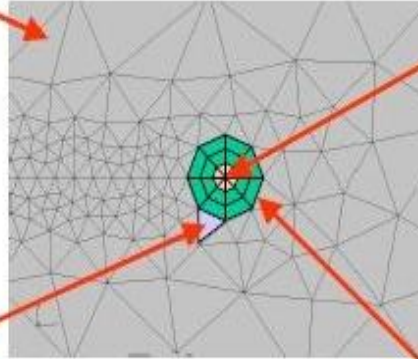

Wedge elements for  
singularity simulation

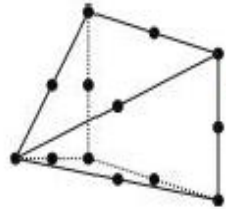

Pyramidal elements for joint  
tetrahedral and parallelepipeds  
elements

Two rings of parallelepipeds  
elements

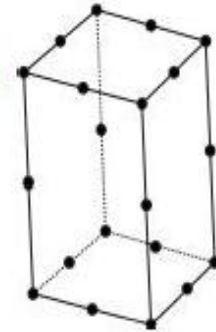

# Method of analysis

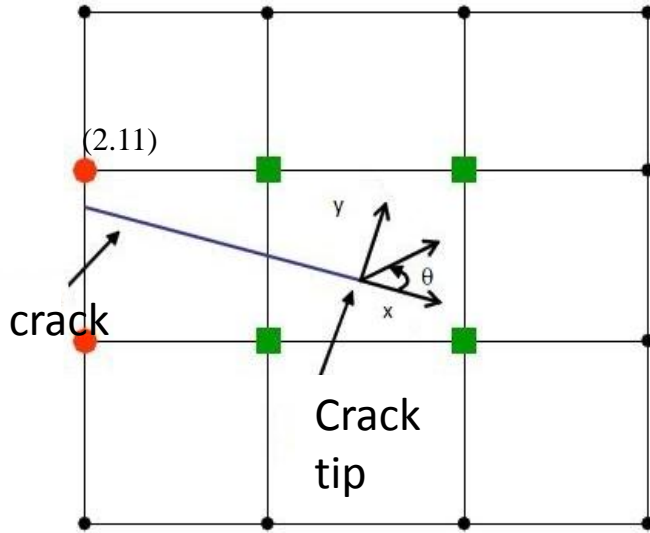

- Extended Finite Element Method (XFEM) by enrichment

This suppresses the need to mesh and remesh the discontinuity surfaces

to calculate the strain energy release rate and the state of stresses:

J -Integral:

$$J = \int_{\Gamma} \left( W dy - T \cdot \frac{\partial u}{\partial x} d\Gamma \right)$$

M -Integral:

$$M^{(1,2)} = \int_A \left[ \left( \sigma_x \frac{\partial u_x^{(2)}}{\partial x} + \tau_{xy} \frac{\partial u_y^{(2)}}{\partial x} + \sigma_x^{(2)} \frac{\partial u_x^{(2)}}{\partial x} + \tau_{xy}^{(2)} \frac{\partial u_y^{(2)}}{\partial x} - \sigma_{ij} \varepsilon_{ij}^{(2)} \right) \frac{\partial q}{\partial x} + \left( \tau_{xy} \frac{\partial u_x^{(2)}}{\partial x} + \sigma_y \frac{\partial u_y^{(2)}}{\partial x} + \tau_{xy}^{(2)} \frac{\partial u_x^{(2)}}{\partial x} + \sigma_y^{(2)} \frac{\partial u_y^{(2)}}{\partial x} \right) \frac{\partial q}{\partial y} \right] dA$$

# Example of the Crack Propagation Sequence

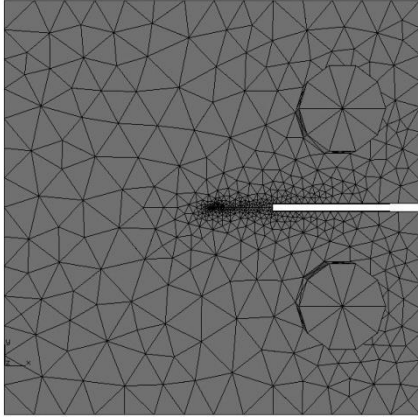

After  $5E+3$  cycles

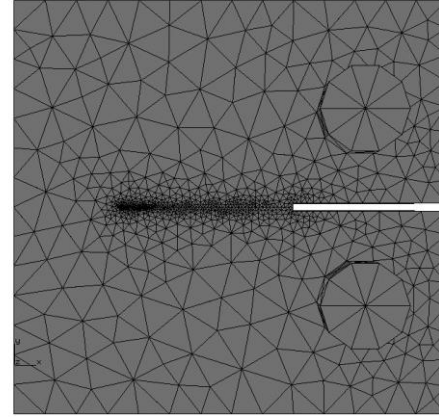

After  $2E+4$  cycles

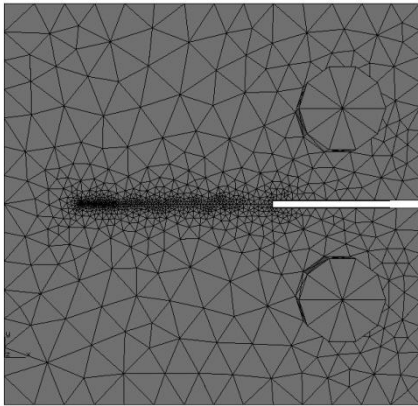

After  $6E+4$  cycles

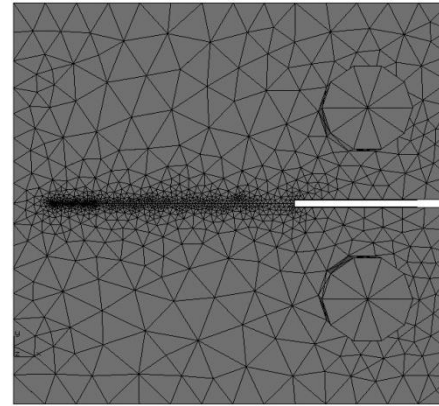

After  $8E+4$  cycles

# Example of the Results

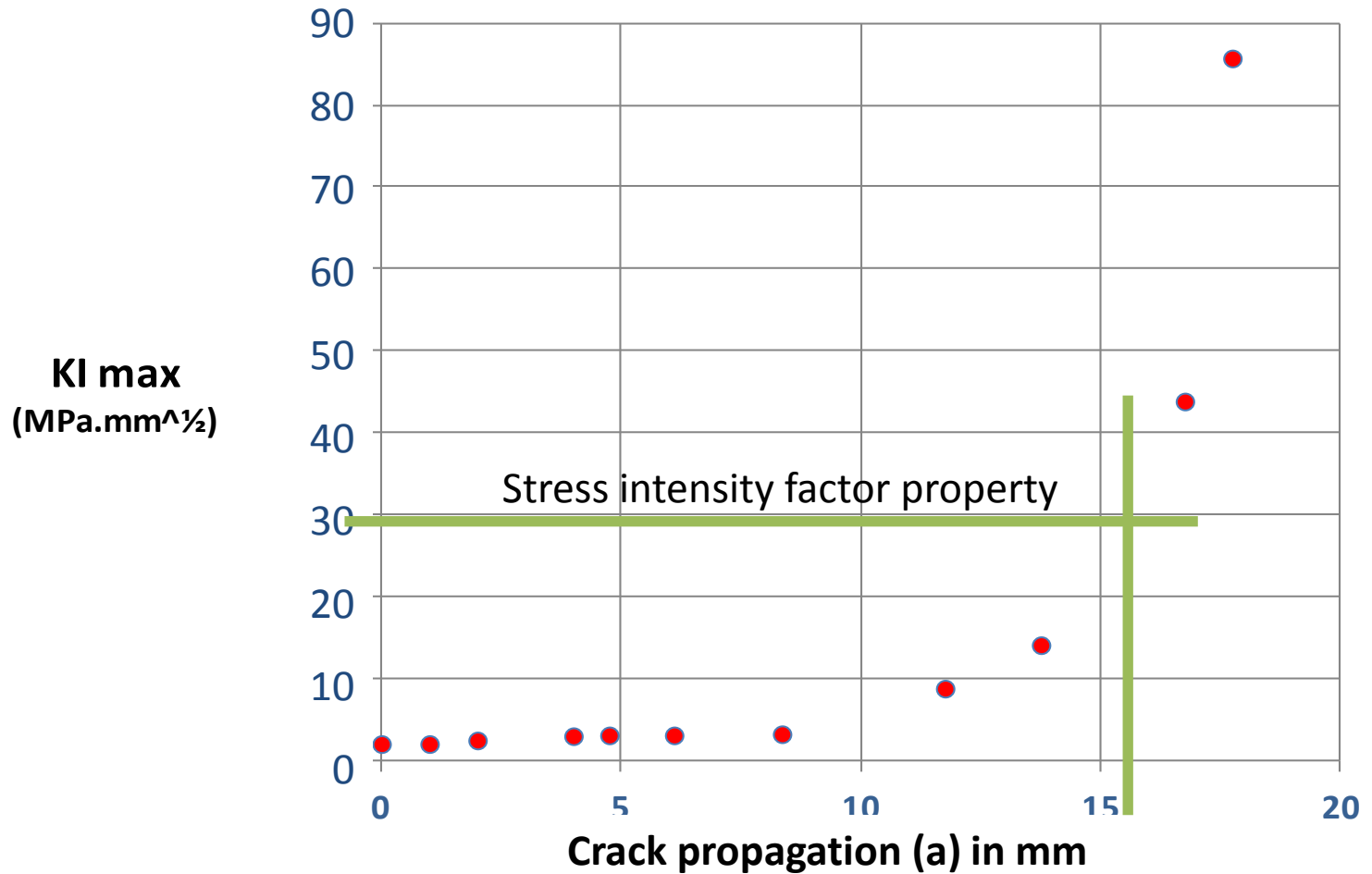

# Results Validation

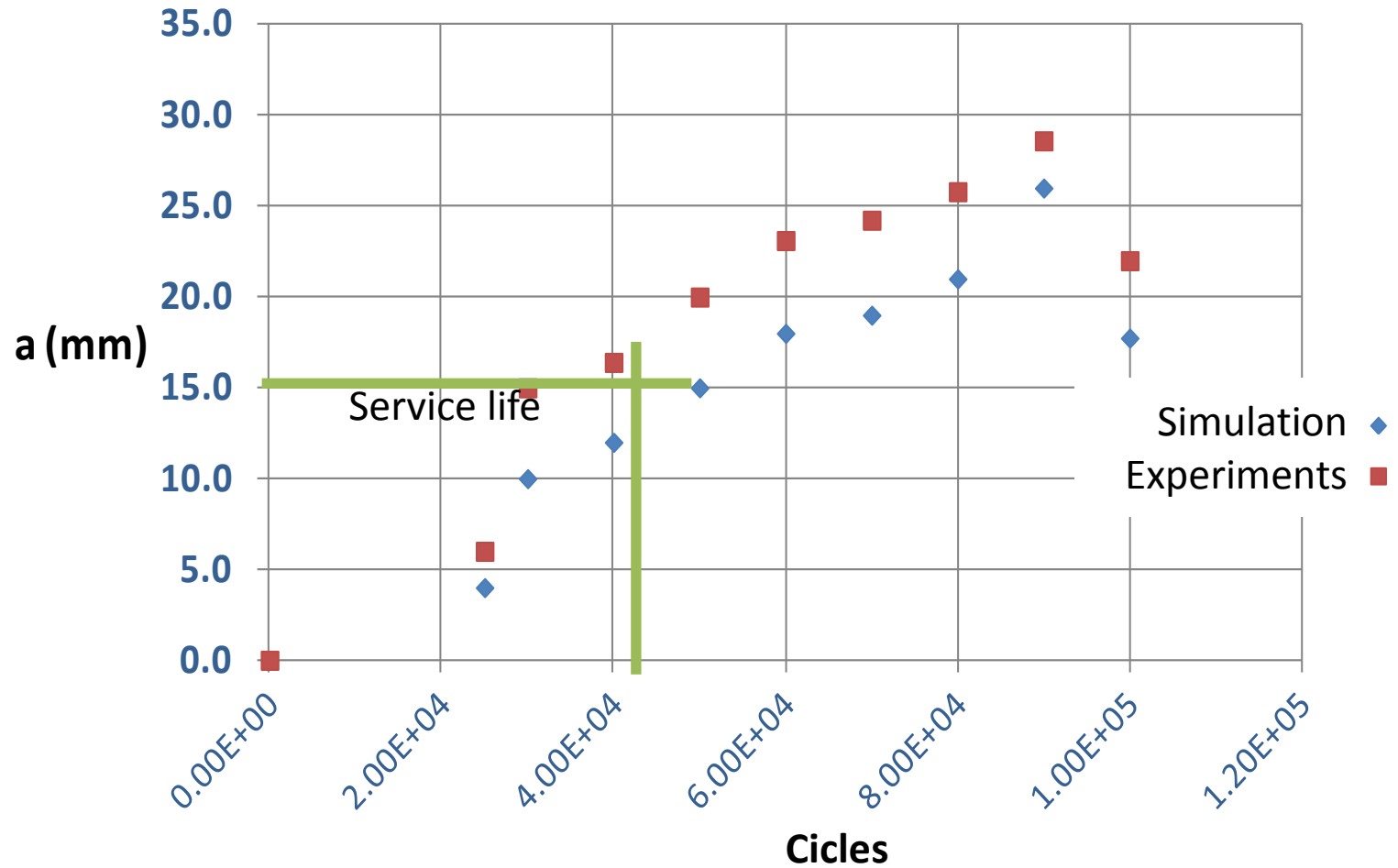

# Outline

1. Introduction

2. Modeling of the crack propagation mechanism

**3. Application to real structures**

4. Analysis of single cracks

5. Analysis of multiple cracks

6. Conclusions

# Model of a Chain

Weight: 25 tons

Length between supports: 70 meter

Failure: some after 2 years  
others after 6 months



# Outline

1. Introduction
2. Modeling of the crack propagation mechanism
3. Application to real structures
- 4. Analysis of single cracks**
5. Analysis of multiple cracks
6. Conclusions



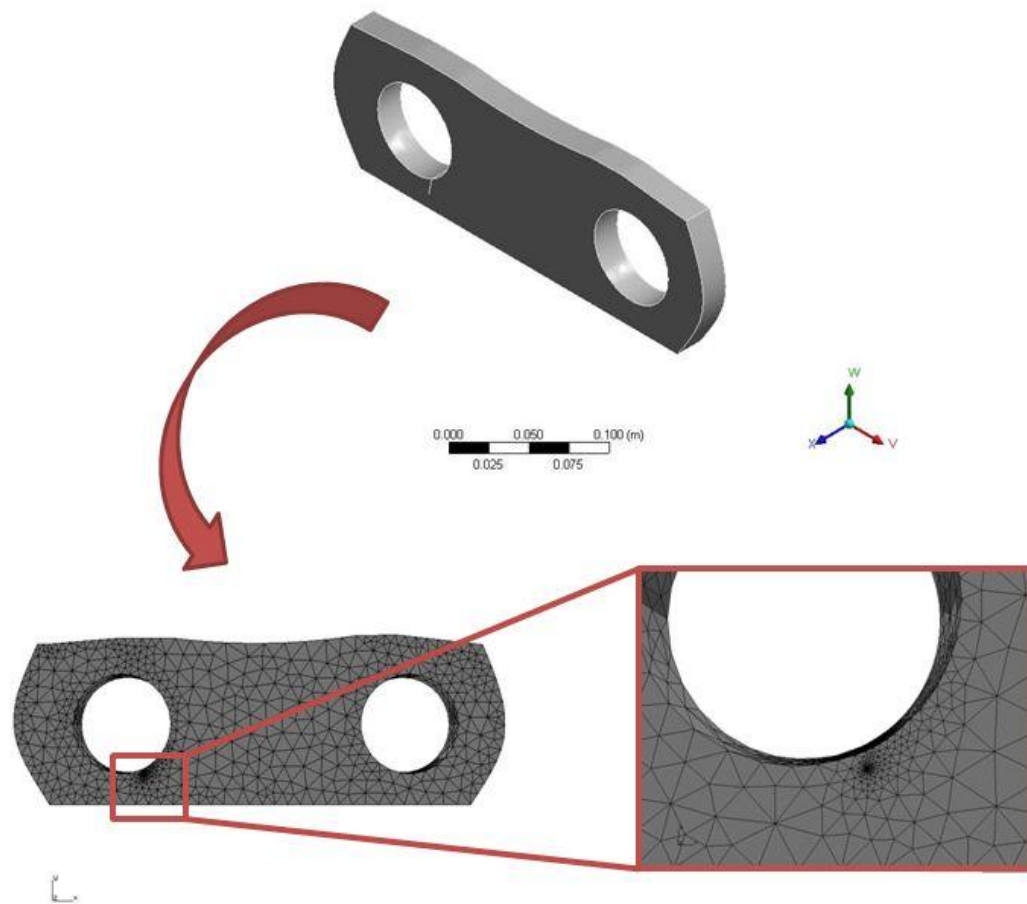

# Example of the Crack Propagation Sequence

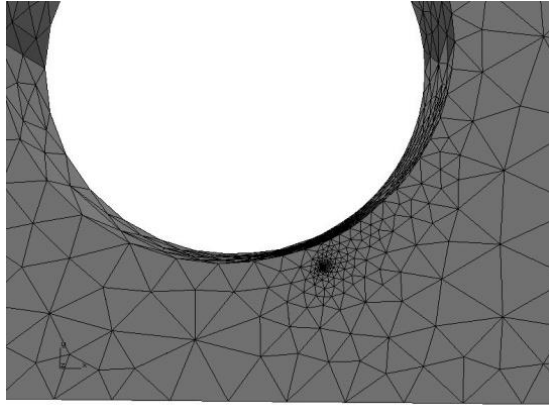

After  $5E+3$  cycles

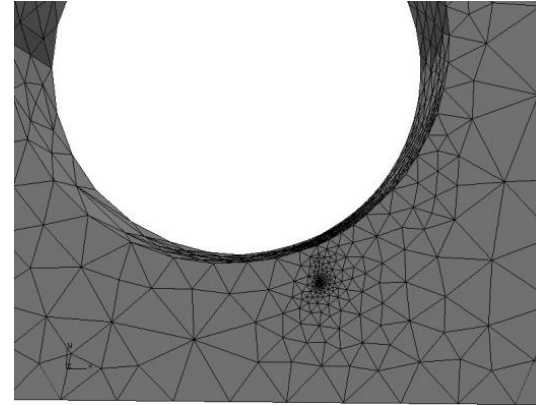

After  $2E+4$  cycles

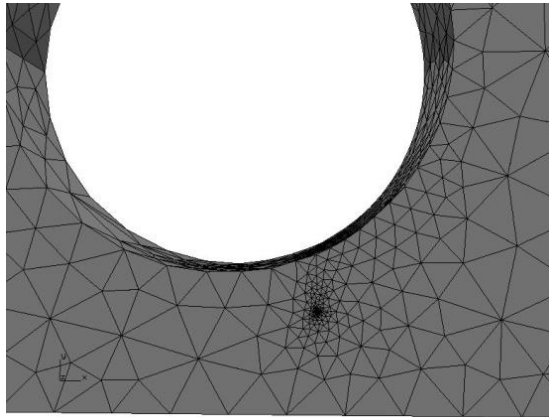

After  $6E+4$  cycles

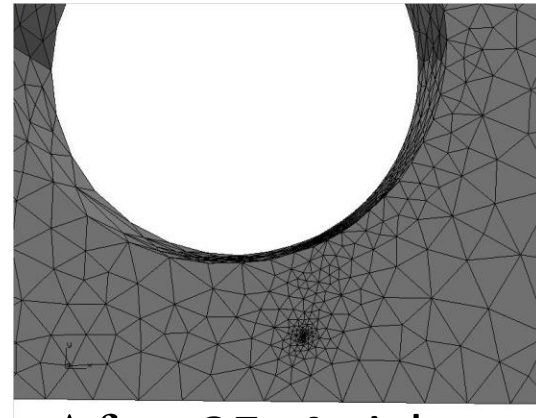

After  $8E+4$  cycles

**B: Static Structural (ANSYS)**

Safety Factor

Type: Safety Factor

Time: 0

06/10/2012 04:51 p.m.

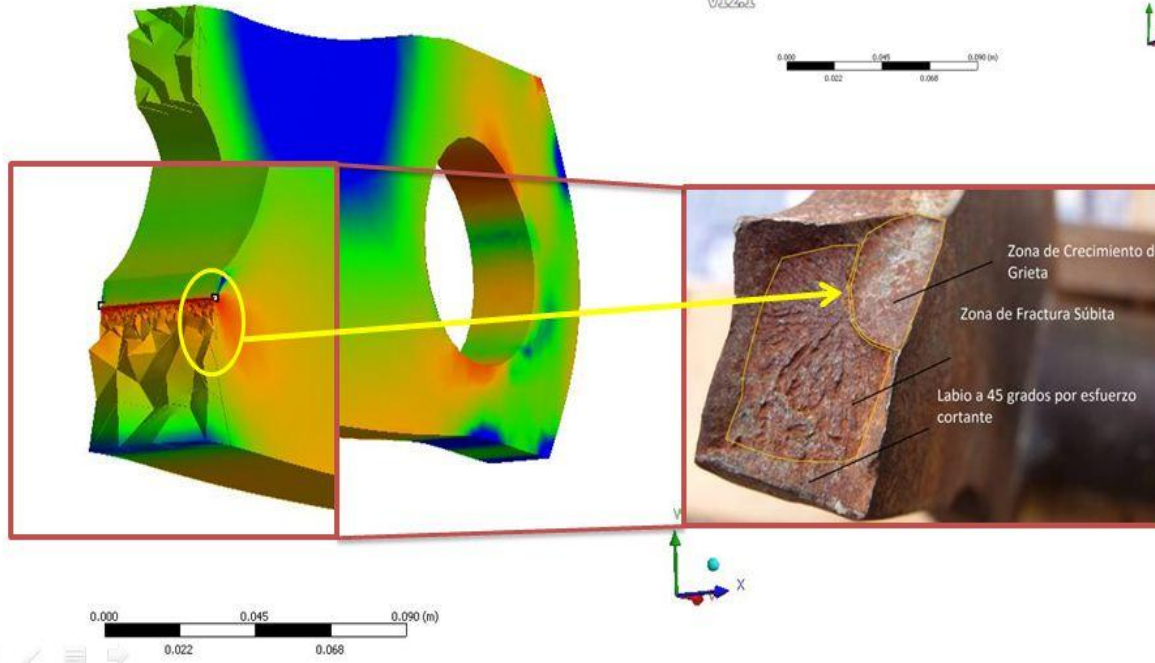
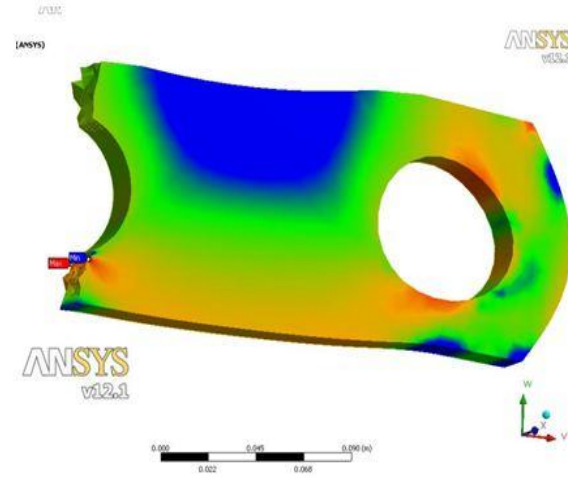
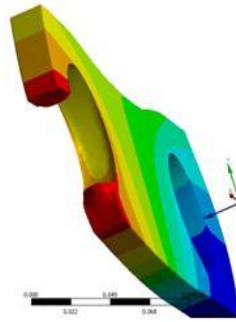

**KI**  
(MPa.mm<sup>½</sup>)

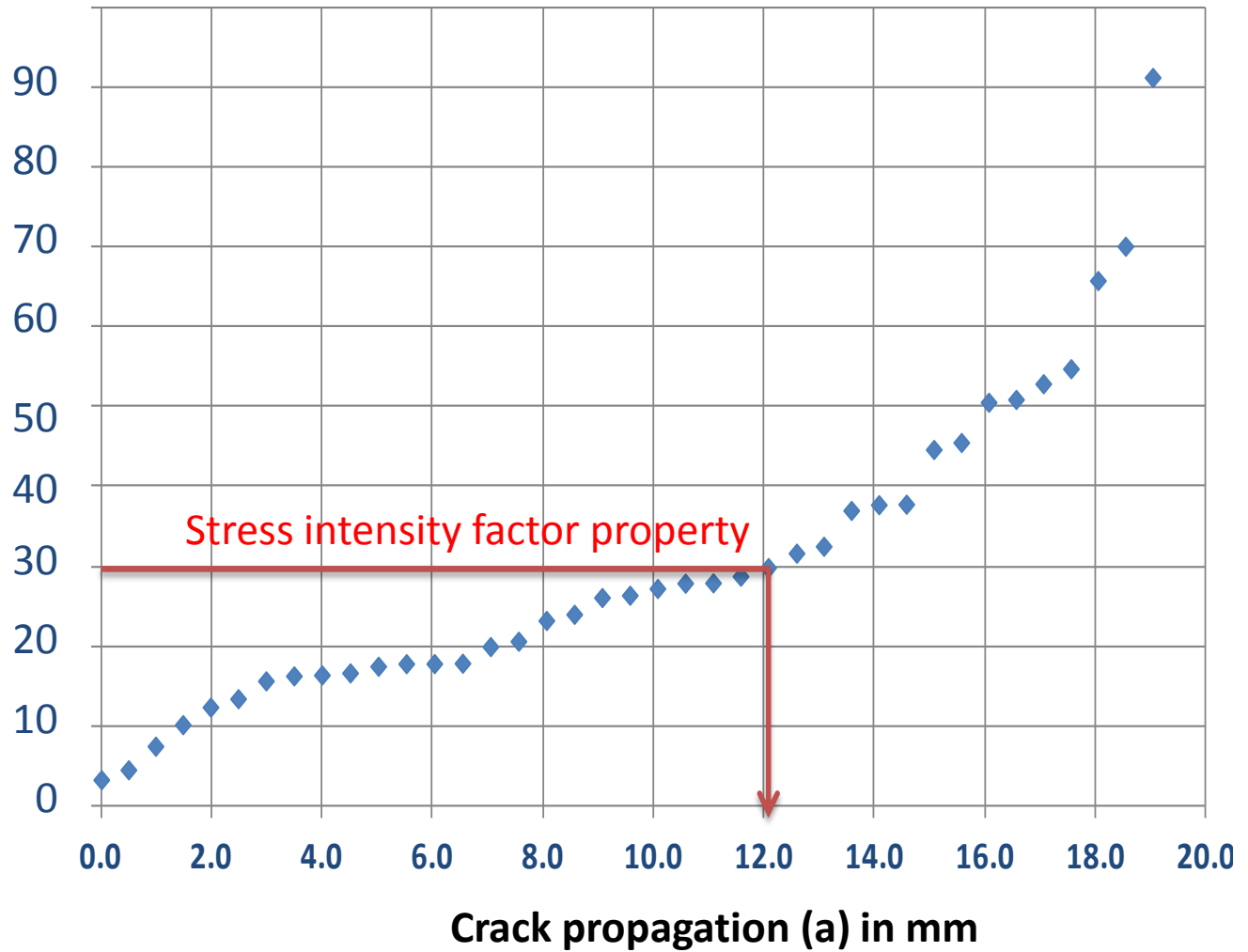

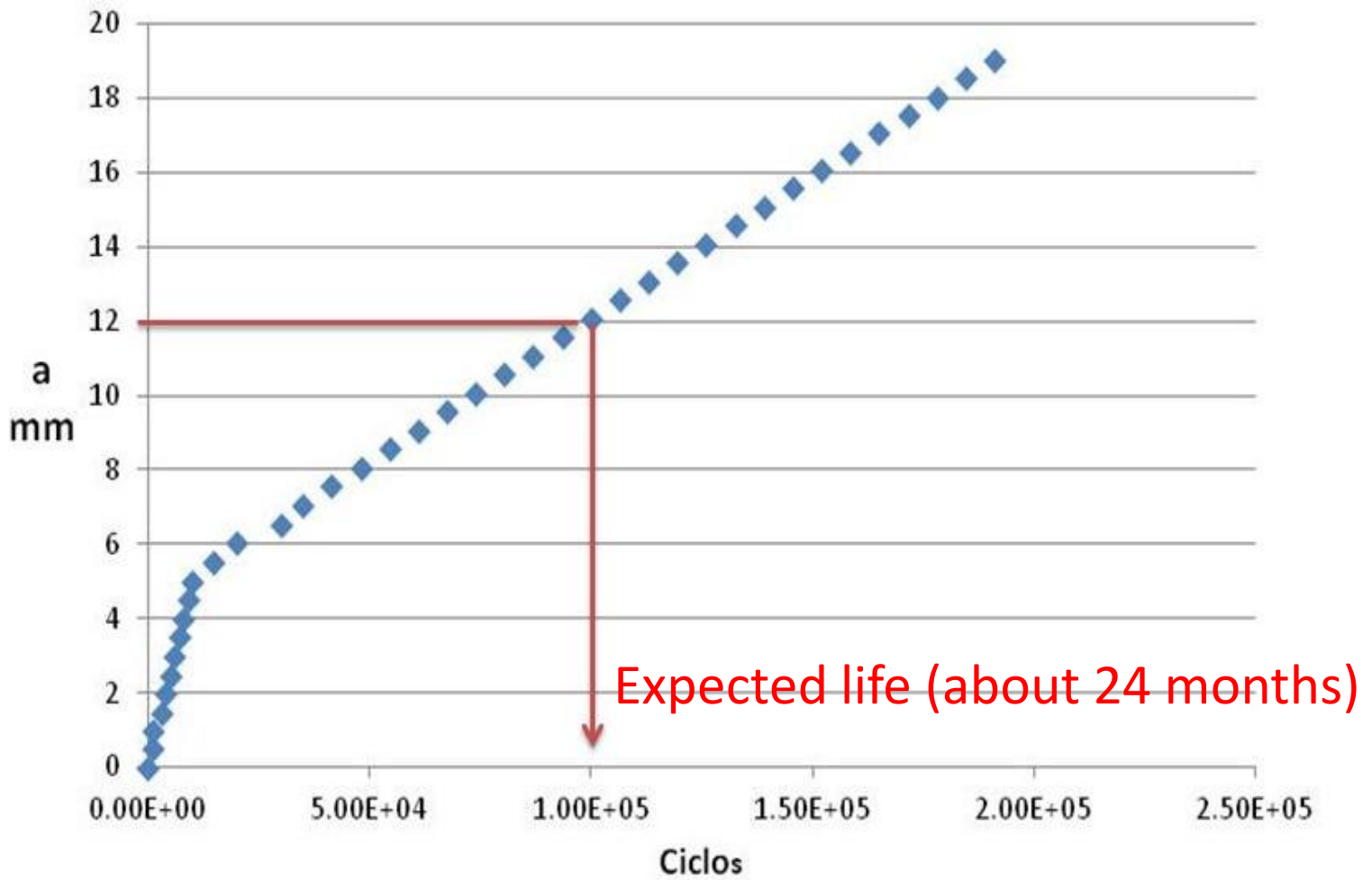

# Outline

1. Introduction
2. Modeling of the crack propagation mechanism
3. Application to real structures
4. Analysis of single cracks
- 5. Analysis of multiple cracks**
6. Conclusions

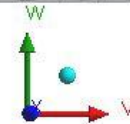
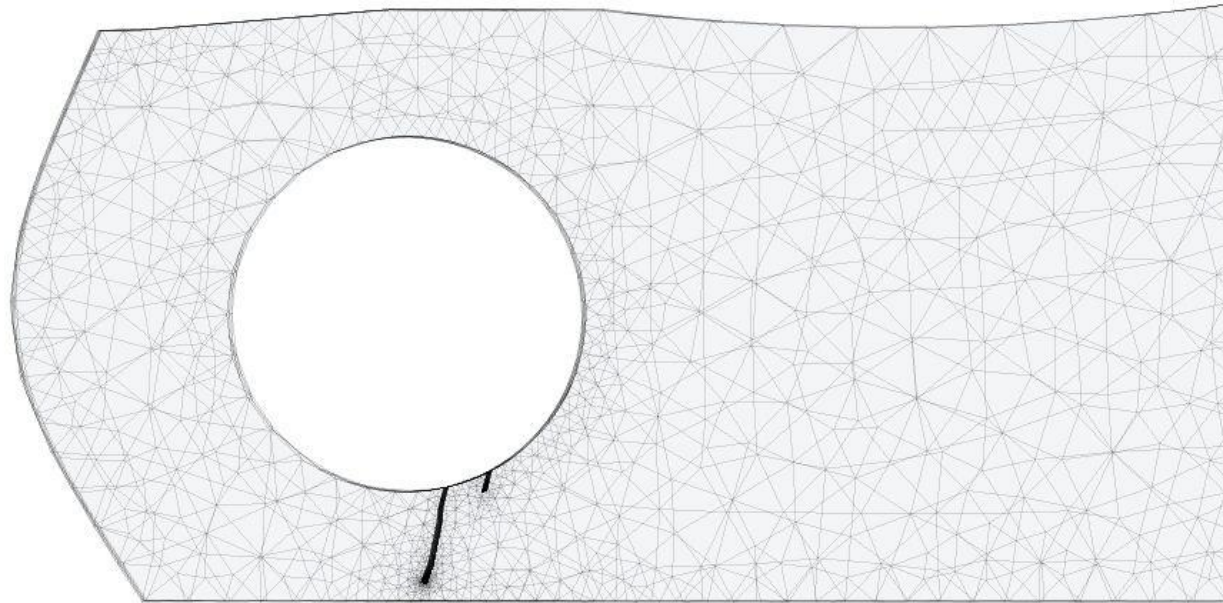

**KI**  
(MPa.mm<sup>½</sup>)

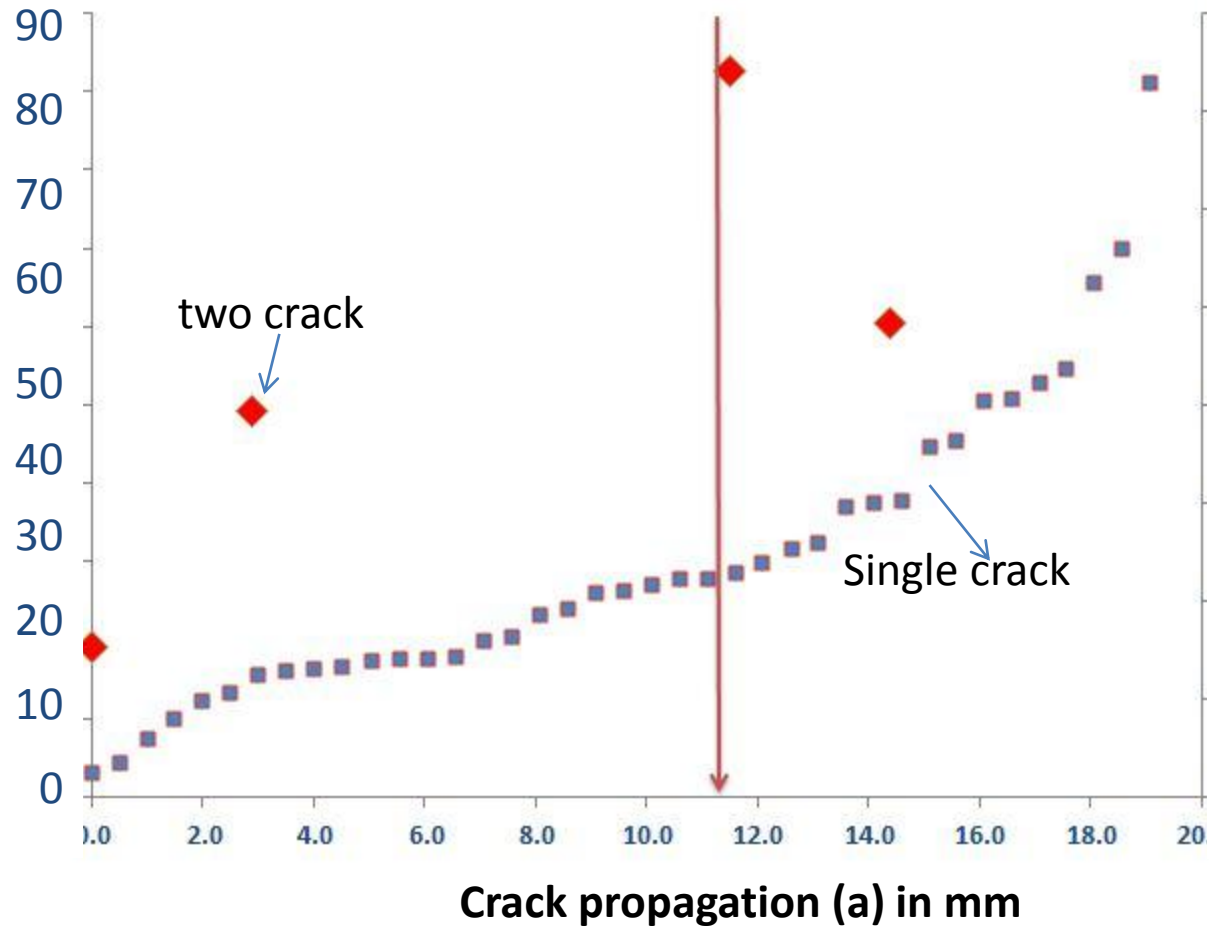



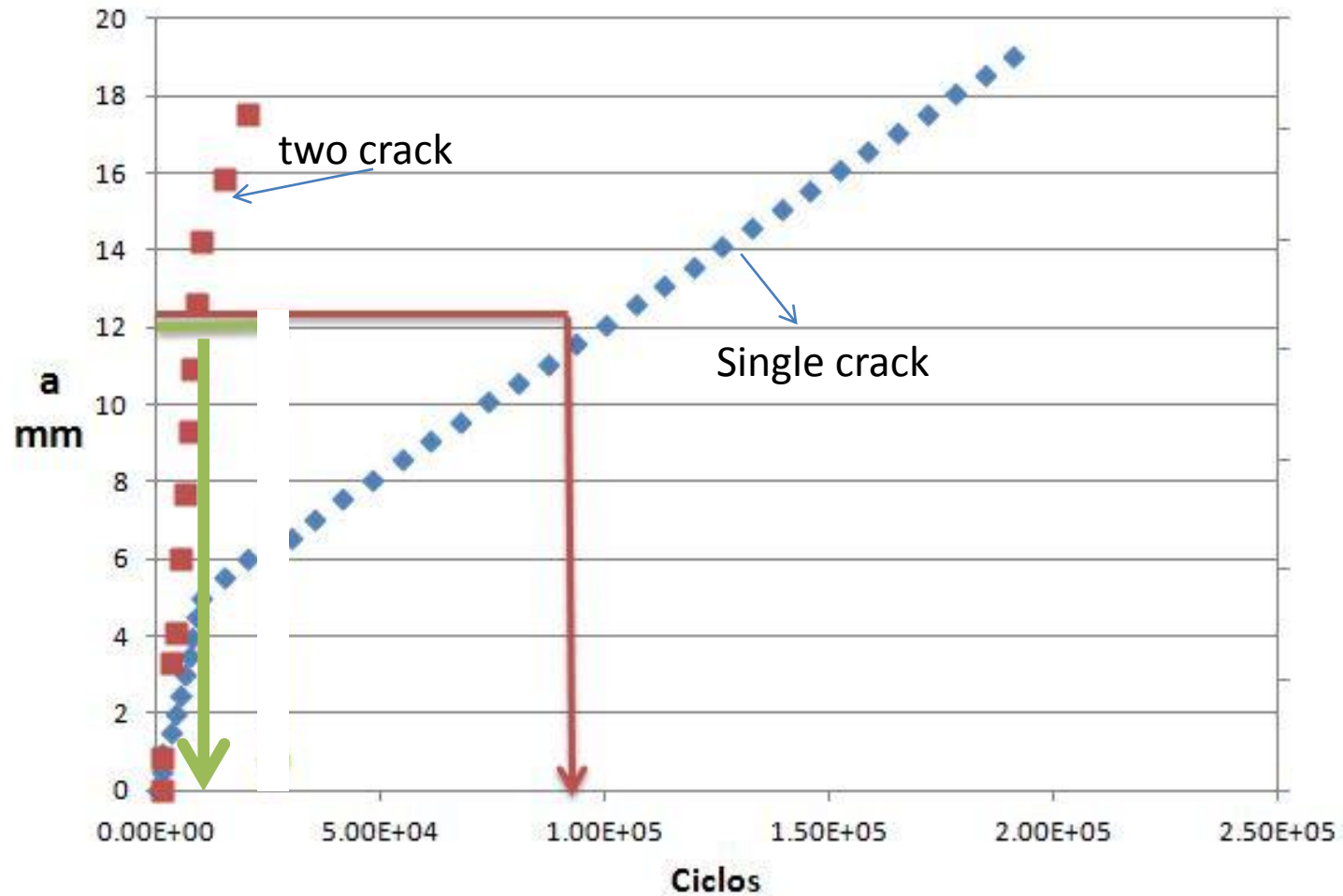

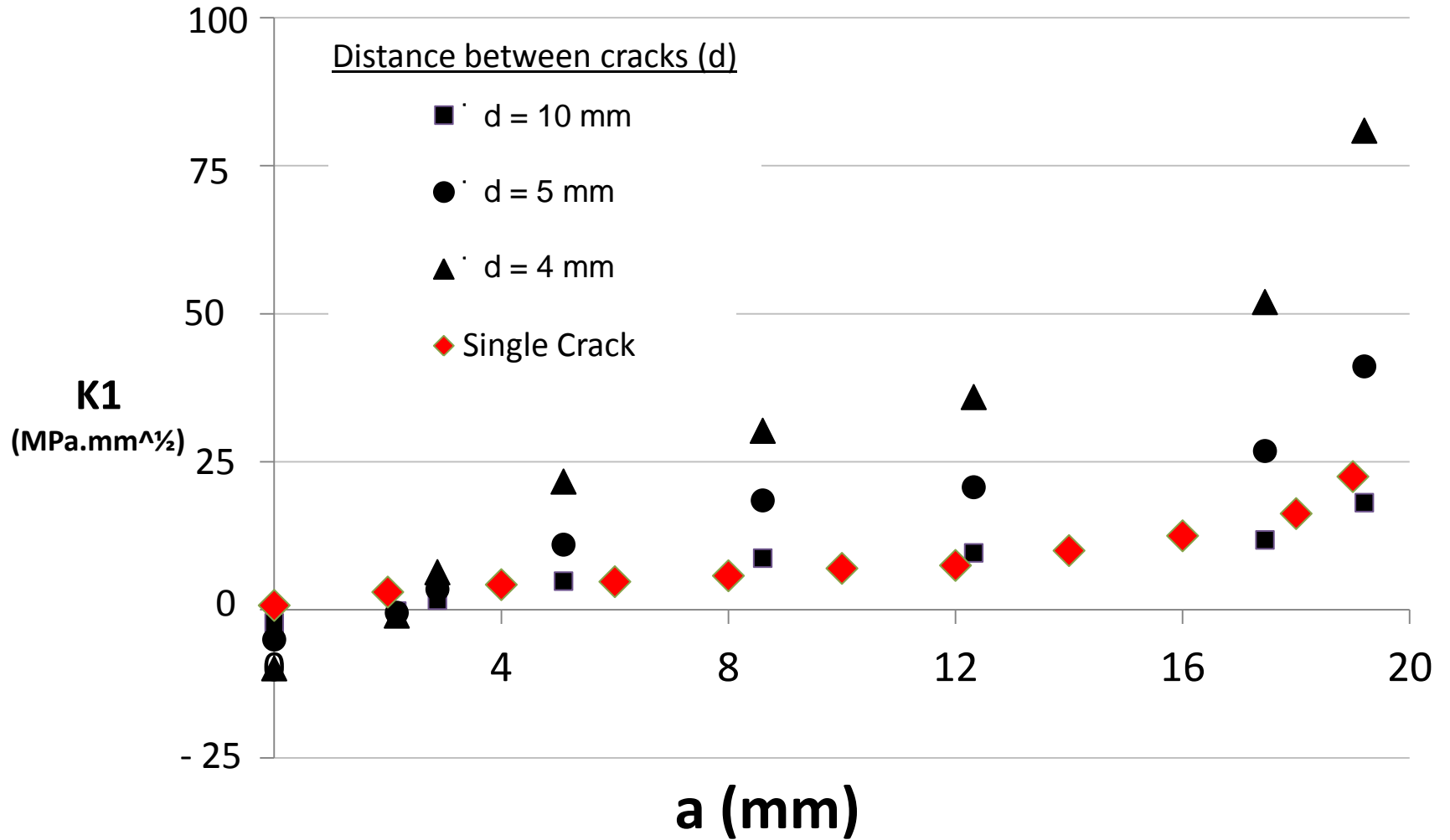

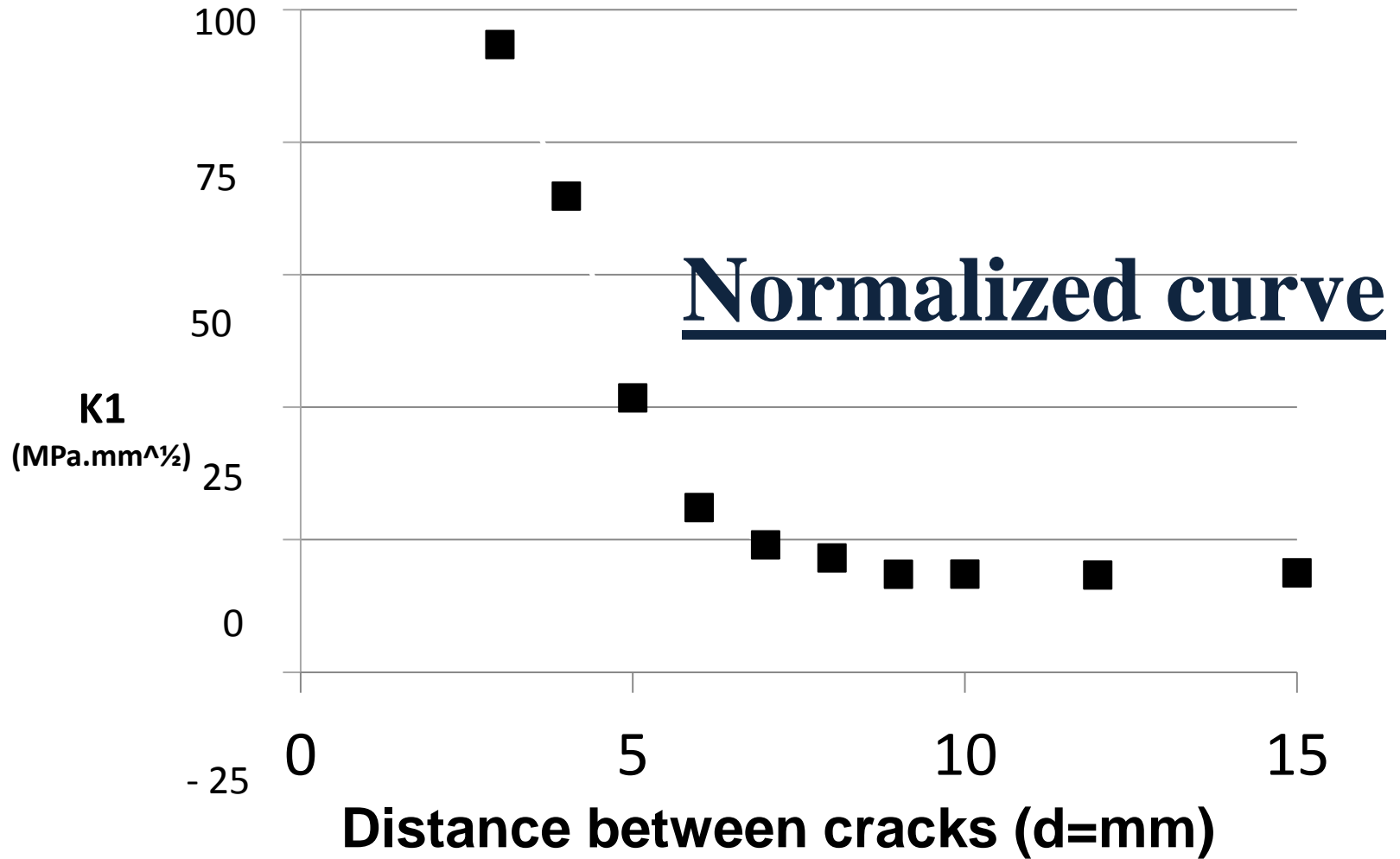

# Outline

1. Introduction
2. Modeling of the crack propagation mechanism
3. Application to real structures
4. Analysis of single cracks
5. Analysis of multiple cracks
- 6. Conclusions**

# conclusions

This work approaches the problems of crack growth and propagation using the Extended Finite Element Method by Enrichment.

Through the application of Enrichment Functions it is possible to lay aside the dependence on remeshing to redirect the new boundaries of the growing crack.

We have studied the influence of two crack on the analysis of crack propagation. We found that for short distance it is necessary to consider both crack.

It is also founded that the effect of a second crack on the crack propagation can be described as a function of the distance between both cracks.

***Thank you very much for kind attention***



**Doctor Adan Vega Saenz**

Technological University of Panama

[www.lepum.utp.ac.pa](http://www.lepum.utp.ac.pa)

Email: [adan.vega@utp.ac.pa](mailto:adan.vega@utp.ac.pa)

Phone: (507) 60198076 / 560-3095